

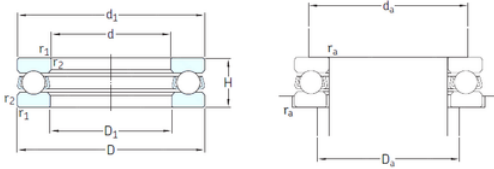

AMERICAN BEARING MFG.CORP.



15UZ2102529T2PX1 Eccentric Bearing / Cylindrical Roller Bearing 15x40.5x28mm

Bearing No. 51109

51109 Bearing 2D drawings and 3D CAD models

| | |
|-------------------------------|---------------------|
| Size | 45x65x14 mm |
| Bore Diameter | 45 mm |
| Outer Diameter | 65 mm |
| Width | 14 mm |
| d | 45 mm |
| D | 65 mm |
| H | 14 mm |
| d1 | 65 mm |
| r1 min. | 0,6 mm |
| r2 min. | 0,6 mm |
| D1 | 47 mm |
| da min. | 57 mm |
| Da max. | 53 mm |
| ra max. | 0,6 mm |
| Weight | 0,14 Kg |
| Basic dynamic load rating (C) | 26,5 kN |
| Basic static load rating (C0) | 69,5 kN |
| Fatigue load limit (Pu) | 2,55 |
| Reference speed | 4500 r/min |
| Limiting speed | 6300 r/min |
| Category | Thrust Ball Bearing |
| Inventory | 0.0 |
| Manufacturer Name | SKF |
| Minimum Buy Quantity | N/A |
| Weight / Kilogram | 0.154 |



AMERICAN BEARING MFG.CORP.

| | |
|-------------------------------------|---|
| Product Group | B00308 |
| Rolling Element | Ball Bearing |
| Thrust Bearing | Yes |
| Single or Double Direction | Single Direction |
| Banded | No |
| Cage Material | Steel |
| Precision Class | ABEC 1 ISO P0 |
| Component Description | Roller Assembly Plus Raceways |
| Other Features | Single Row |
| Long Description | 45MM Bore 1; 47MM Bore 2; 65MM Outside Diameter; 14MM Height; Ball Bearing; Single Direction; Not Banded; Steel Cage; ABEC 1 ISO P0 Precision |
| Inch - Metric | Metric |
| Category | Thrust Ball Bearings |
| UNSPSC | 31171507 |
| Harmonized Tariff Code | 8482.10.50.08 |
| Noun | Bearing |
| Keyword String | Ball Thrust |
| Manufacturer URL | http://www.skf.com |
| Manufacturer Item Number | 51109 |
| Weight / LBS | 0.339 |
| Overall Height with Aligning Washer | 0 Inch 0 Millimeter |
| Outside Diameter | 2.559 Inch 65 Millimeter |
| Height | 0.551 Inch 14 Millimeter |
| Bore 2 | 1.85 Inch 47 Millimeter |
| Bore 1 | 1.772 Inch 45 Millimeter |
| bore diameter: | 45 mm |
| static load capacity: | 69.5 kN |
| outside diameter: | 65 mm |
| | |



AMERICAN BEARING MFG.CORP.

| | |
|---|---------------------------|
| dynamic load capacity: | 26.5 kN |
| overall width: | 14 mm |
| maximum rpm: | 6300 RPM |
| thrust bearing type: | Single-Direction |
| cage material: | Steel |
| outside diameter design: | Straight |
| fillet radius: | 0.6 mm |
| separable or banded: | Separable |
| series: | 511 |
| precision rating: | ABEC 1 (ISO Class Normal) |
| d_1 | 65 mm |
| D_1 | 47 mm |
| $r_{1,2}$ min. | 0.6 mm |
| d_a min. | 57 mm |
| D_a max. | 53 mm |
| r_a max. | 0.6 mm |
| Basic dynamic load rating C | 26.5 kN |
| Basic static load rating C_0 | 69.5 kN |
| Fatigue load limit P_u | 2.55 kN |
| Minimum load factor A | 0.025 |
| Mass bearing (including seat washer where applicable) | 0.14 kg |